

THREADED REDUCING TEE GRTD

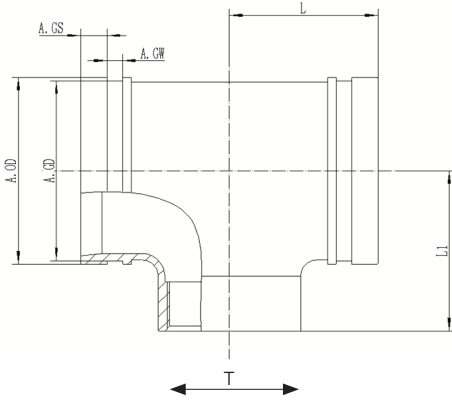

Threaded reducing tees provide an economical and efficient method of adding a reduced threaded branch connection.

Reference		Nominal size		Pipe Ø O.D. - T	Threaded reducing tee dimensions						Weight	Marking
Red	Galva	NPS inch	DN mm	mm	L mm	L1 mm	A OD mm	A GD mm	A GS mm	A GW mm	kg	
GRTDR	GRTDG	2 x 1	50 x 25	60,3 x 1	70	70	60,3	57,2	15,88	7,93	0,93	GRTD
GRTDR	GRTDG	2 x 1¼	50 x 32	60,3 x 1¼	70	70	60,3	57,2	15,88	7,93	0,96	GRTD
GRTDR	GRTDG	2 x 1½	50 x 40	60,3 x 1½	70	70	60,3	57,2	15,88	7,93	0,95	GRTD
GRTDR	GRTDG	2½ x 1	65 x 25	73,0 x 1	76	76	73	69,1	15,88	7,93	1,25	GRTD
GRTDR	GRTDG	2½ x 1¼	65 x 32	73,0 x 1¼	76	76	73	69,1	15,88	7,93	1,35	GRTD
GRTDR	GRTDG	2½ x 1½	65 x 40	73,0 x 1½	76	76	73	69,1	15,88	7,93	1,35	GRTD
GRTDR	GRTDG	2½ x 1	65 x 25	76,1 x 1	76	76	76,1	72,3	15,88	7,93	1,25	GRTD
GRTDR	GRTDG	2½ x 1¼	65 x 32	76,1 x 1¼	76	76	76,1	72,3	15,88	7,93	1,35	GRTD
GRTDR	GRTDG	2½ x 1½	65 x 40	76,1 x 1½	76	76	76,1	72,3	15,88	7,93	1,36	GRTD
GRTDR	GRTDG	2½ x 2	65 x 50	76,1 x 2	76	76	76,1	72,3	15,88	7,93	1,35	GRTD
GRTDR	GRTDG	3 x 1	80 x 25	88,9 x 1	86	86	88,9	84,9	15,88	7,93	1,72	GRTD
GRTDR	GRTDG	3 x 1¼	80 x 32	88,9 x 1¼	86	86	88,9	84,9	15,88	7,93	1,75	GRTD
GRTDR	GRTDG	3 x 1½	80 x 40	88,9 x 1½	86	86	88,9	84,9	15,88	7,93	1,75	GRTD
GRTDR	GRTDG	3 x 2	80 x 50	88,9 x 2	86	86	88,9	84,9	15,88	7,93	1,70	GRTD
GRTDR	GRTDG	3 x 2½	80 x 65	88,9 x 2½	86	86	88,9	84,9	15,88	7,93	1,85	GRTD
GRTDR	GRTDG	4 x 1½	100 x 40	108,0 x 1½	90	98	108	103,7	15,88	9,53	2,31	GRTD*
GRTDR	GRTDG	4 x 2	100 x 50	108,0 x 2	90	98	108	103,7	15,88	9,53	3,00	GRTD*
GRTDR	GRTDG	4 x 2½	100 x 65	108,0 x 2½	90	98	108	103,7	15,88	9,53	2,70	GRTD*
GRTDR	GRTDG	4 x 3	100 x 80	108,0 x 3	90	98	108	103,7	15,88	9,53	2,70	GRTD*
GRTDR	GRTDG	4 x 1	100 x 25	114,3 x 1	90	98	114,3	110,1	15,88	9,53	2,20	GRTD
GRTDR	GRTDG	4 x 1¼	100 x 32	114,3 x 1¼	90	98	114,3	110,1	15,88	9,53	2,30	GRTD
GRTDR	GRTDG	4 x 1½	100 x 40	114,3 x 1½	90	98	114,3	110,1	15,88	9,53	2,31	GRTD
GRTDR	GRTDG	4 x 2	100 x 50	114,3 x 2	90	98	114,3	110,1	15,88	9,53	2,08	GRTD
GRTDR	GRTDG	4 x 2½	100 x 65	114,3 x 2½	90	98	114,3	110,1	15,88	9,53	1,90	GRTD
GRTDR	GRTDG	4 x 3	100 x 80	114,3 x 3	90	98	114,3	110,1	15,88	9,53	2,35	GRTD
GRTDR	GRTDG	5 x 2	125 x 50	133,0 x 2	105	105	133	129,1	15,88	9,53	3,50	GRTD*
GRTDR	GRTDG	5 x 2½	125 x 65	133,0 x 2½	105	105	133	129,1	15,88	9,53	4,35	GRTD*
GRTDR	GRTDG	5 x 3	125 x 80	133,0 x 3	105	105	133	129,1	15,88	9,53	4,75	GRTD*
GRTDR	GRTDG	5 x 4	125 x 100	133,0 x 4	105	105	133	129,1	15,88	9,53	-	GRTD*
GRTDR	GRTDG	5 x 1¼	125 x 32	139,7 x 1¼	105	105	139,7	135,5	15,88	9,53	4,50	GRTD
GRTDR	GRTDG	5 x 1½	125 x 40	139,7 x 1½	105	105	139,7	135,5	15,88	9,53	4,50	GRTD

THREADED REDUCING TEE GRTD



Reference		Nominal size		Pipe Ø O.D. - T	Threaded reducing tee dimensions						Weight	Marking
Red	Galva	NPS inch	DN mm	mm	L mm	L1 mm	A OD mm	A GD mm	A GS mm	A GW mm	kg	
GRTDR	GRTDG	5 x 2	125 x 50	139,7 x 2	105	105	139,7	135,5	15,88	9,53	3,65	GRTD
GRTDR	GRTDG	5 x 2½	125 x 65	139,7 x 2½	105	105	139,7	135,5	15,88	9,53	3,83	GRTD
GRTDR	GRTDG	5 x 3	125 x 80	139,7 x 3	105	105	139,7	135,5	15,88	9,53	3,86	GRTD
GRTDR	GRTDG	5 x 4	125 x 100	139,7 x 4	105	105	139,7	135,5	15,88	9,53	3,98	GRTD
GRTDR	GRTDG	5 x 1½	125 x 40	141,3 x 1½	105	105	141,3	137,0	15,88	9,53	4,50	GRTD
GRTDR	GRTDG	5 x 2	125 x 50	141,3 x 2	105	105	141,3	137,0	15,88	9,53	3,90	GRTD
GRTDR	GRTDG	5 x 2½	125 x 65	141,3 x 2½	105	105	141,3	137,0	15,88	9,53	3,83	GRTD
GRTDR	GRTDG	5 x 3	125 x 80	141,3 x 3	105	105	141,3	137,0	15,88	9,53	3,86	GRTD
GRTDR	GRTDG	5 x 4	125 x 100	141,3 x 4	105	105	141,3	137,0	15,88	9,53	-	GRTD
GRTDR	GRTDG	6 x 1½	150 x 40	159,0 x 1½	110	120	159,0	154,5	15,88	9,53	5,78	GRTD*
GRTDR	GRTDG	6 x 2	150 x 50	159,0 x 2	110	120	159,0	154,5	15,88	9,53	6,88	GRTD*
GRTDR	GRTDG	6 x 2½	150 x 65	159,0 x 2½	110	120	159,0	154,5	15,88	9,53	4,50	GRTD*
GRTDR	GRTDG	6 x 3	150 x 80	159,0 x 3	110	120	159,0	154,5	15,88	9,53	7,00	GRTD*
GRTDR	GRTDG	6 x 4	150 x 100	159,0 x 4	110	120	159,0	154,5	15,88	9,53	7,60	GRTD*
GRTDR	GRTDG	6 x 2	150 x 50	165,1 x 2	110	120	165,1	160,9	15,88	9,53	4,80	GRTD
GRTDR	GRTDG	6 x 2½	150 x 65	165,1 x 2½	110	120	165,1	160,9	15,88	9,53	4,85	GRTD
GRTDR	GRTDG	6 x 3	150 x 80	165,1 x 3	110	120	165,1	160,9	15,88	9,53	4,80	GRTD
GRTDR	GRTDG	6 x 4	150 x 100	165,1 x 4	110	120	165,1	160,9	15,88	9,53	5,50	GRTD
GRTDR	GRTDG	6 x 1½	150 x 40	168,3 x 1½	110	120	168,3	163,9	15,88	9,53	6,00	GRTD*
GRTDR	GRTDG	6 x 2	150 x 50	168,3 x 2	110	120	168,3	163,9	15,88	9,53	9,98	GRTD
GRTDR	GRTDG	6 x 2½	150 x 65	168,3 x 2½	110	120	168,3	163,9	15,88	9,53	10,00	GRTD
GRTDR	GRTDG	6 x 3	150 x 80	168,3 x 3	110	120	168,3	163,9	15,88	9,53	8,55	GRTD
GRTDR	GRTDG	6 x 4	150 x 100	168,3 x 4	110	120	168,3	163,9	15,88	9,53	14,00	GRTD
GRTDR	GRTDG	8 x 2	200 x 50	219,1 x 2	146	146	219,1	214,4	19,05	11,1	10,68	GRTD*
GRTDR	GRTDG	8 x 2½	200 x 65	219,1 x 2½	146	146	219,1	214,4	19,05	11,1	11,53	GRTD
GRTDR	GRTDG	8 x 3	200 x 80	219,1 x 3	146	146	219,1	214,4	19,05	11,1	9,90	GRTD
GRTDR	GRTDG	8 x 4	200 x 100	219,1 x 4	146	146	219,1	214,4	19,05	11,1	14,00	GRTD

Material specifications

Housing: ductile iron in accordance with ASTM A536 GR 65-45-12

Coating:

- Hot dip galvanised
- Red paint coating RAL 3000, EPD Epoxy coating

Working pressure

300 psi/2068 kPa/20,7 barg

THREADED PART STANDARD BSPT-THREAD
AVAILABLE WITH NPT-THREAD

General notes:

- * No FM- and UL-approval
- Pressure ratings listed are CWP (cold working pressure) or MWP (maximum working pressure) at a maximum service temperature of 50°C. This rating may occasionally differ from maximum working pressure listed and / or approved by UL and / or FM, as testing conditions and test pipes can differ. For more information, please contact info@pipinglogistics.eu.
- Maximum working pressure listed is the total of internal and external pressures based on standard weight (ANSI) steel pipe and standard roll or cut groove in accordance with Profit specifications. For more information, please contact info@pipinglogistics.eu.
- For one time field test only, the maximum joint working pressure may be increased by 150% the figure shown.
- Warning: Piping systems must always be depressurised and drained before attempting disassembly and / or removal of any components.
- Profit reserves the right to change specifications, designs and / or standard equipment without notice and without incurring in any obligations.
- Profit red coated products are intended for piping with indoor application (EN 12944-2 corrosivity category C1 & C2). For outdoor installations near the sea (corrosivity category C3) we advise the use of our hot dip galvanised couplings and fittings. For application in corrosivity category C4 (higher salinity climate) or higher, please contact info@pipinglogistics.eu.
- We advise to always store our products in closed and dry environments.