

NIPPLE GROOVED ADAPTER NGA

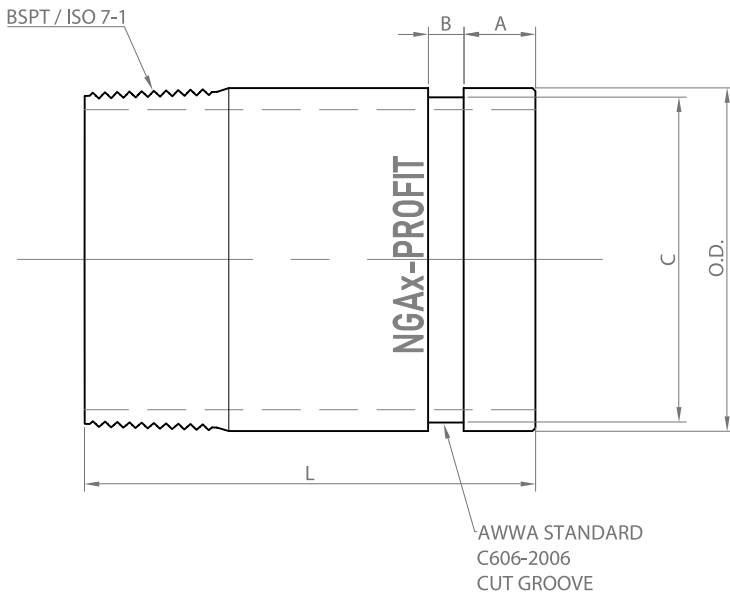

Nipple grooved adapters allow the connection between threaded and grooved end equipment.

Reference		Nominal size		Pipe Ø O.D.	Nipple grooved adapter dimensions				Weight	Marking
Black uncoated	Zinc electroplated	NPS inch	DN mm	mm	L mm	A mm	B mm	C mm	kg	
NGA1 - BLACK	NGA1 - GALVA	1	25	33,7	75	15,9	7,9	30,2	0,15	NGA
NGA1¼ - BLACK	NGA1¼ - GALVA	1¼	32	42,4	100	15,9	7,9	39,0	0,30	NGA
NGA1½ - BLACK	NGA1½ - GALVA	1½	40	48,3	100	15,9	7,9	45,1	0,34	NGA
NGA2 - BLACK	NGA2 - GALVA	2	50	60,3	100	15,9	7,9	57,2	0,47	NGA
NGA2½ - BLACK	NGA2½ - GALVA	2½	65	76,1	100	15,9	7,9	72,3	0,68	NGA
NGA3 - BLACK	NGA3 - GALVA	3	80	88,9	100	15,9	7,9	84,9	0,72	NGA
NGA4 - BLACK	NGA4 - GALVA	4	100	114,3	100	15,9	9,5	110,1	1,09	NGA

Material specifications

Body: carbon steel

Surface finish: black uncoated / zinc electroplated

Working pressure

300 PSI / 2068 kPa / 20,7 barg

General notes:

- Pressure ratings listed are CWP (cold working pressure) or MWP (maximum working pressure) at a maximum service temperature of 110°C. For more information, please contact info@pipinglogistics.eu.
- Maximum working pressure listed is total of internal and external pressures, based on standard weight (ANSI) steel pipe and standard roll or cut groove, in accordance with Profit specifications. For more information, please contact info@pipinglogistics.eu.
- For one time field test only, the maximum joint working pressure may be increased one and a half times the figure shown.
- Warning: Piping systems must always be depressurized and drained before attempting disassembly and/or removal of any components.
- Profit reserves the right to change specifications, designs and/or standard equipment without notice and without incurring in any obligations.
- We strongly advise to always store our products in closed and dry warehouses.